



45 4 Lambarde Square, Greenwich, London, SE10 9GB
£1,900 Per month



45 4 Lambarde Square, Greenwich, London, SE10 9GB

£1,900 Per month

A beautifully presented one bed top floor apartment in Greenwich Square SE10.

With a spacious layout, private balcony and an abundance of amenities close by.

Greenwich Square includes a Sainsburys Local, Costa Coffee, Thai restaurant, dentist, yoga studio, Council run leisure center and library.

In excellent condition and with views of the inner square.

Offered furnished and available 15th September.

Description

A beautifully presented one bed top floor apartment in Greenwich Square SE10.

With a spacious layout, private balcony and an abundance of amenities close by.

Greenwich Square includes a Sainsburys Local, Costa Coffee, Thai restaurant, dentist, yoga studio, Council run leisure center and library.

In excellent condition and with views of the inner square.

Offered furnished.

Situation

Close to Maze Hill mainline BR station that takes you into most mainline terminal stations in central London.

Outside the development are bus links to various places in SE and E London and also to the Jubilee line station at North Greenwich which is less than 10 minutes away by bus.

Furnished

Council Tax Band: B

Available: 15th May 2026



Floor Plans

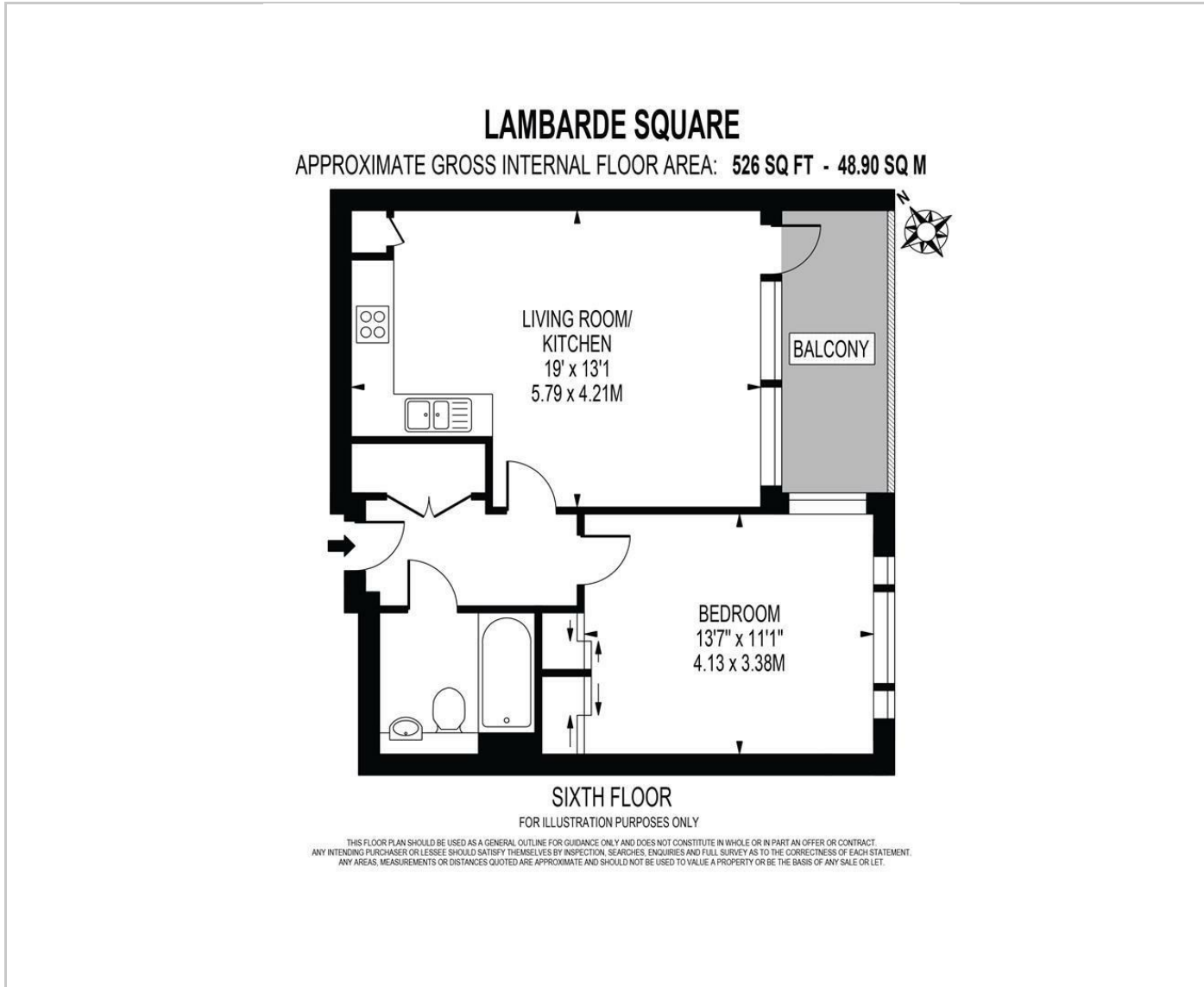

Area Map

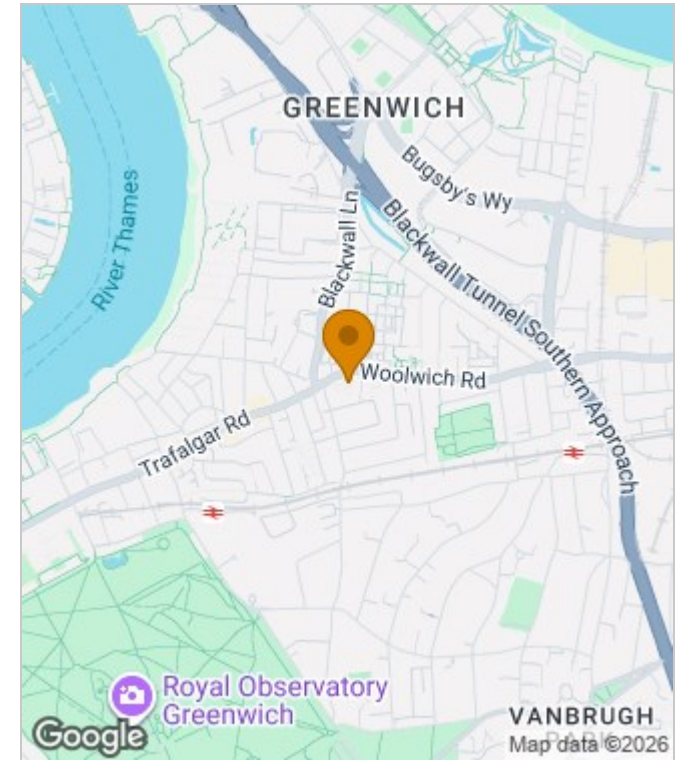

Energy Performance Graph

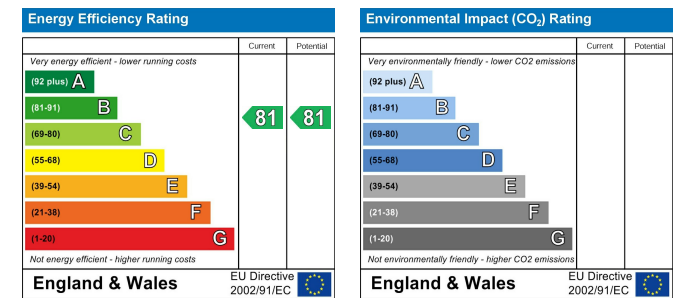

These particulars, whilst believed to be accurate are set out as a general outline only for guidance and do not constitute any part of an offer or contract. Intending purchasers should not rely on them as statements of representation of fact, but must satisfy themselves by inspection or otherwise as to their accuracy. No person in this firm's employment has the authority to make or give any representation or warranty in respect of the property.

The Nucleus Brunel Way, Dartford, Kent, DA1 5GA

Tel: 02081758868 Email: property@lyhpropertyconsultants.com www.lyhpropertyconsultants.com